

COMPOST



Why waste it? When you can compost it.



Fruit and
Vegetable scraps
(Cooked & Raw)



Seafood, Meat
and Bones
(Cooked & Raw)



Tea Bags and
Coffee Grounds



Egg and Oyster
Shells



Dairy Products
(Cheese & Yoghurt)

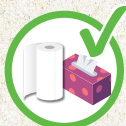

Paper Towels
and Tissues



Lawn Clippings



Weeds



Flowers



Garden
Clippings



Shredded Paper



Pet Waste



NO Plastic Bags
or any Plastic



NO Hoses,
Irrigation Pipe
or Garden Tools



NO Bricks, Rocks,
Dirt or Building
Materials



eastwaste.com.au

EastWaste

COMPOST



**Please
compost in
your green
bin:**

- ✓ Food scraps (including citrus, onion, dairy, meat, bones, fish, fruit and vegetable scraps)
- ✓ Compostable kitchen caddy liners, must be certified compostable (as supplied through Council)
- ✓ Tea leaves and tea bags
- ✓ Coffee grounds
- ✓ Egg and oyster shells
- ✓ Tissue and paper towel
- ✓ Lawn clippings
- ✓ Weeds
- ✓ Cut flowers
- ✓ Small cuttings, prunings and branches
- ✓ Shredded paper (loose/not bagged)
- ✓ Pet waste (no plastic bags or kitty litter)
- ✓ Sawdust
- ✓ Hair and nail clippings

**Many of these items can also be composted
in your home compost.**

**Please DO NOT place any plastics including bags,
irrigation pipe, hoses, bottle caps, or metals
in the green organics bin.**

For more information on what can be composted
through the green bin go to:

whichbin.sa.gov.au

EastWaste